



**Battery powered crimping tool  
„SDE240-6“**

**Art. 216669**



<b>60 kN</b>	<b>700 bar</b>	<b>180°</b>		<b>Li-ION 18V 2Ah</b>		<b>SysCon</b>	

10-240 standard

10-240 standard



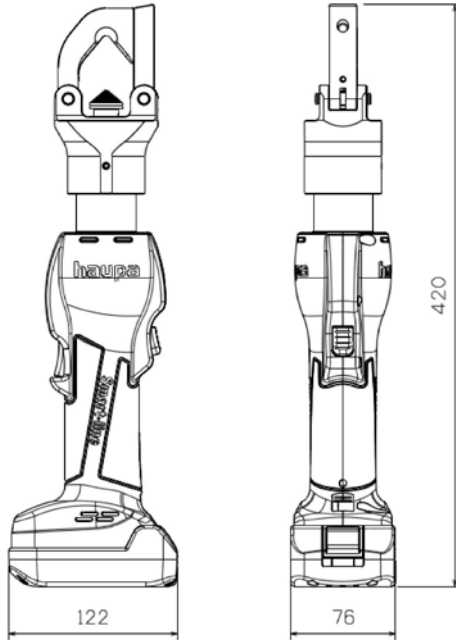

<b>SPECIFICATION</b>			
<b>Art.</b>	216669		
<b>OUTPUT</b>	6t		
<b>VOLTAGE</b>	18 V DC		
<b>WEIGHT</b>	2,9 KGS (without battery)		
<b>DIMENSION</b>	420 x 76 x 122mm (LxWxH)		
<b>ACCESSORY</b>	battery & charger & case & manual		
<b>APPLICATION</b>	copper & aluminium terminal & conduct crimping		
<b>CRIMPING RANGE</b>		DIN	AWG/MCM
	copper	10-240mm <sup>2</sup>	8-500
	aluminium	50-240mm <sup>2</sup>	1-500

**REMARKS BEFORE OPERATION OR WHILE OPERATING:**

- Please wear protective equipment while operating to make sure your safety. Warning: This tool is not insulated.
- If the release button is not returned, please try to reduce the pressure of safety valve till leaking out the pressure.
- Please kindly check the crimping range and suitable crimping material. Please make sure that your crimping material is suitable for this tool and your crimping material is in the range of 216669. (You could find the range at this manual on page 1). Do not crimp without any material in crimping area, otherwise the tool will be damaged.
- Please do not put your hands/fingers in the working area while operating, cleaning and testing. This action is very dangerous.
- Please do not aim at anyone while operating. This action is very dangerous.

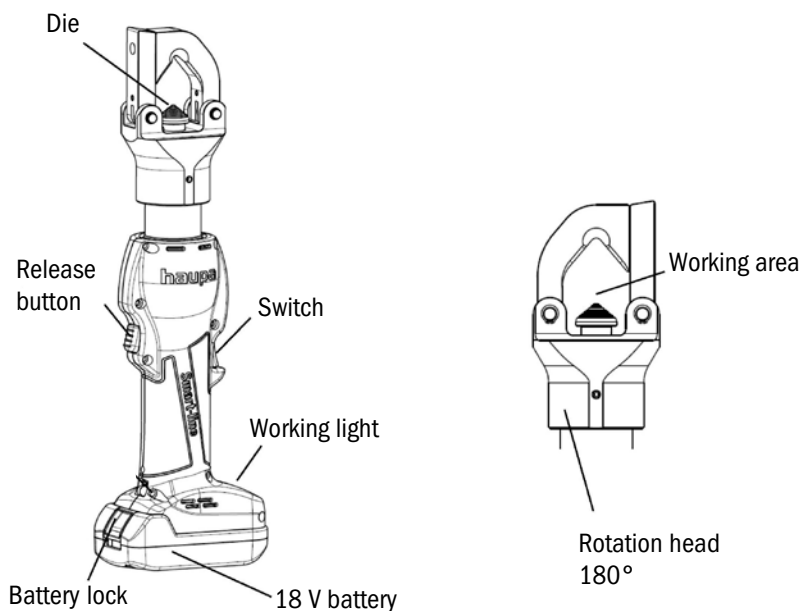

## HOW TO USE CHARGER Art. 215513:

- The charger Art. 215513 is suitable for Li-Ion battery (Li-Ion) 215511 (4Ah) and 215503 (2Ah). The voltage of charger: 18V.
- While connecting to power, the digital monitor shows **bor**. The buzzer buzzes once.
- Already connected to power, but the battery is not in the charger, the digital monitor shows **bor** and twinkles once a second.
- After inserting the battery in, the charger will detect the battery voltage and show the capacity in percentage.
- If the battery is well charged, the digital monitor shows **100**. The buzzer buzzes every 5 seconds.
- The voltage of battery is low, the digital monitor shows **Low**. The buzzer buzzes once a second, it means the battery error/defect.
- The temperature of battery is over, the digital monitor shows **Err**. The buzzer buzzes once a second, you have to wait until the battery is cool down, then you could charge the battery.
- After charging 10 minutes, the voltage is not rising, the digital monitor shows **bor**. The buzzer buzzes once two seconds and stops one second, it means the battery error/defect.
- The max. charging time is about 60-70 minutes. After 70 minutes, no matter the battery is full charged or not, the charger will be stopped.
- While charging, the digital monitor shows the capacity in percentage each 5% until 90%. After 90% of capacity, it will show the capacity in percentage each 1% until full charged, i.e. 100%.
- There is a protecting system that while the battery is full charged, it will stop charging automatically. And if the battery temperature is over 65 degree, it will stop charging automatically, too.

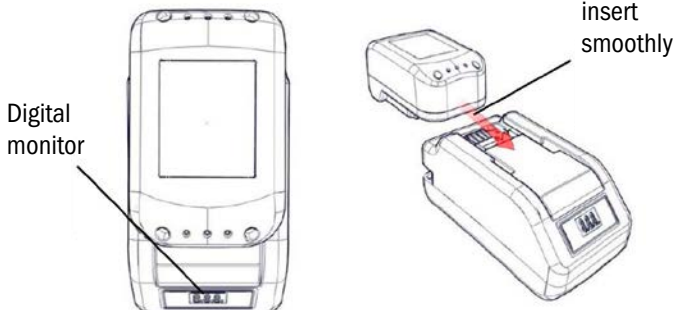
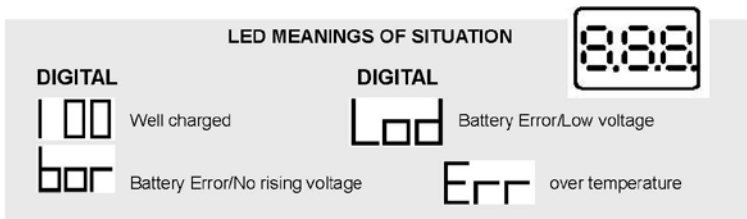

**Charging only for HAUPA batteries!**

**ABOUT THE 18V LI-ION BATTERY (18 V): 215511 and 215503:**

**Art. 215511 (4Ah)**

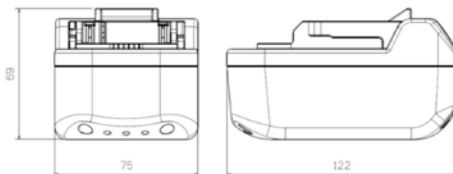

SPECIFICATION	
<b>ART.</b>	215511
<b>VOLTAGE</b>	18V
<b>WEIGHT</b>	0,5 kg
<b>DIMENSION</b>	122 x 75 x 69mm (LxWxH)
<b>CHARGING TIME</b>	120 minutes
<b>CAPACITY</b>	4Ah
<b>MEMORY EFFECT</b>	NO

**Art. 215503 (1,5Ah)**

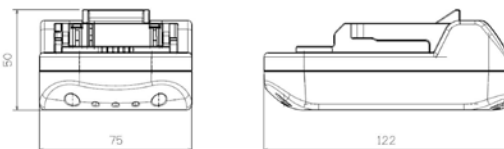
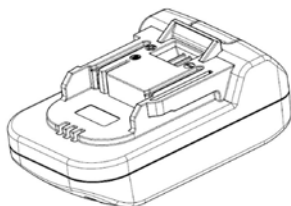

SPECIFICATION	
<b>ART.</b>	215503
<b>VOLTAGE</b>	18V
<b>WEIGHT</b>	0,3 kg
<b>DIMENSION</b>	122 x 75 x 50mm (LxWxH)
<b>CHARGING TIME</b>	60 minutes
<b>CAPACITY</b>	2 Ah
<b>MEMORY EFFECT</b>	NO

Please follow the manual of battery with correct instruction. Our company does not guarantee anything due to the purpose damage or wrong use.

**haupa**

**... convincing solutions**

## MANUAL/INSTRUCTION OF BATTERY:

Voltage	9,6 V	14,4V	18V	CURRENT	CHARGING
Ni-MH	B-03	B-02		4 Ah	120 min.
LI-ION				4 Ah	120 min.
				2 Ah	60 min.

### BEFORE OPERATION PLEASE NOTE:

- Do not put the battery together with any metal. Otherwise the battery may have a short circuit.
- Do not store the battery at a wet/hot space. Put battery in a dry clean space.
- Do not give the battery to children. Keep the battery away from the children.
- The electric capacity of battery may be lost and the battery may be damaged if the battery is put in the tool or charger for a long time.
- Do not heat the battery or put the battery in the fire.
- Keep the battery away from water, no matter sea water or faucet water. Please keep the battery dry & clean.
- Do not press/take apart/throw down the battery. Do not let the battery near the water or fire. Also do not put the battery in your pocket.
- Do not destroy the housing/package/body of battery.
- Do not use old transformed battery with strange/abnormal appearance.
- The battery after use will be a little warm.
- The battery in low temperature (10 degree or below), the battery will be deteriorated and its use time will be shorter. This is normal.
- Please follow the instruction of battery manual to charge the battery.
- Do not charge the battery directly under the sun or in a space with high temperature.
- Please use charger to charge the same brand battery.
- Do not use battery with other brand.
- Please charge the battery before storage if you will not use the battery for a long time. Please charge the battery at least once a month to ensure its life.

### HOW TO CLEAN THE BATTERY:

- If the connecting points (+/-) or the cap of battery is dirty. It may cause the electric current cannot go through. Therefore you will find the digital monitor will still show "Without Power" under full charged.
- Please keep the connecting points (+/-) or the cap of battery clean. Please use dry soft cloth to wipe the battery housing/cap and even the connecting points (+/-).
- Do not use cleaner or chemical cleaner to clean the battery or charger, otherwise they will be damaged.

### RECYCLING & THROW AWAY:

- Make sure there is without any power inside the battery before throwing the battery away.
- Please charge the battery full at the first time use. If the battery's use time is shorter after long time use, it means you need to amend an extra new battery.
- Please stick gummed tapes on the connecting points (+/-) for fire/explosion preventing. Please follow the local rule of recycling.



## HOW TO USE 216669: CRIMPING STEPS

- Insert the battery to 216669 as below picture 1: While the battery is inserted the battery lock will lock the battery.

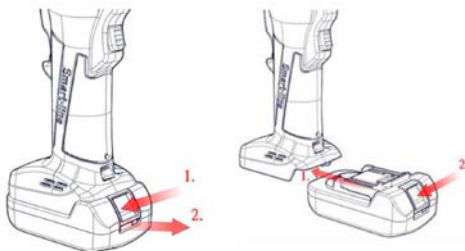

Picture 1: Set/Take battery

- After setting suitable crimping material, then you could use the start switch and the oil return switch to operate the tool. The tool will move forward and backward to crimp.



Picture 2: Operation

**haupa**

**... convincing solutions**

## **STORAGE:**

- The hydraulic oil for 216669:  
Add/use hydraulic oil SHEEL TELLUS T-15 or SEA#20. Do not use other brand. Otherwise the tool will be damaged. We also can supply you hydraulic oil. Welcome to inquire for Factory Brand Oil T-15.
- Put the tool, charger and battery in a dry dean place. Please charge the battery full once two months to make sure the life time. Clean the tool and add some antirust oil on the metal parts, i.e. dies, dies holders before storage.

## **BREAKDOWN SOLVING:**

- The crimper can not operate to the original position and while operating, the speed is very slow: Please contact your distributor.